

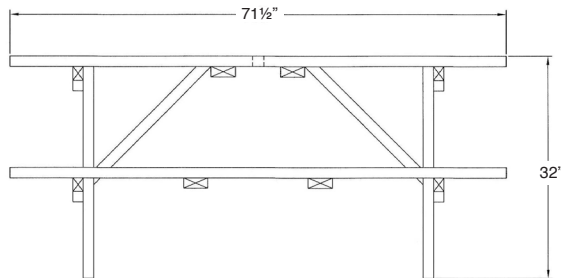

PICNIC table

home.crs

DIMENSIONS



LONG SIDE VIEW

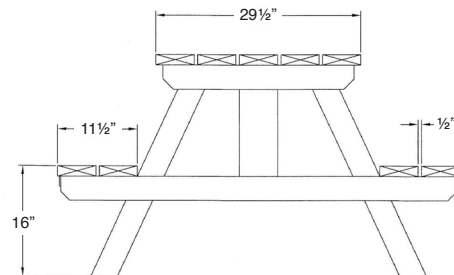

SHORT SIDE VIEW

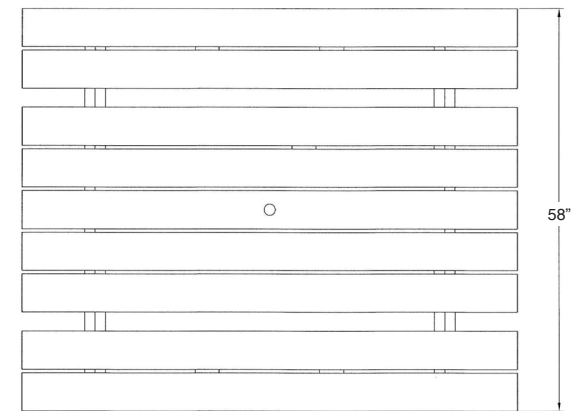

TOP VIEW

MATERIALS LIST

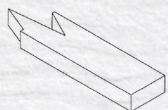

Pressure Treated
2x4, 12-ft.
• 3 boards

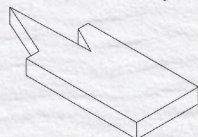

Pressure Treated
2x6, 12 ft.
• 5 boards



Coated Deck Screws
• 2-1/2" long, 60 (0.6 lbs.)
• 3" long, 36 (0.35 lbs.)

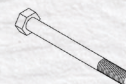

3/8" x 3-1/2" Hex Bolts
• 16 bolts



3/8" Flat Washers
• 32 washers



3/8" Hex Nuts
• 16 nuts

PICNIC TABLE CONSTRUCTION

1 CUTTING THE COMPONENTS

The **Cutting Diagrams** show how each piece of lumber is to be broken down. Refer to the **Detail Drawings** to determine the shape of complex components. The components are numbered in the order they are assembled.

CUTTING DIAGRAMS

2x4 Pressure Treated Lumber

All boards are 12' long. Three (3) boards are required for components #1, 2, 3, 5, & 7.

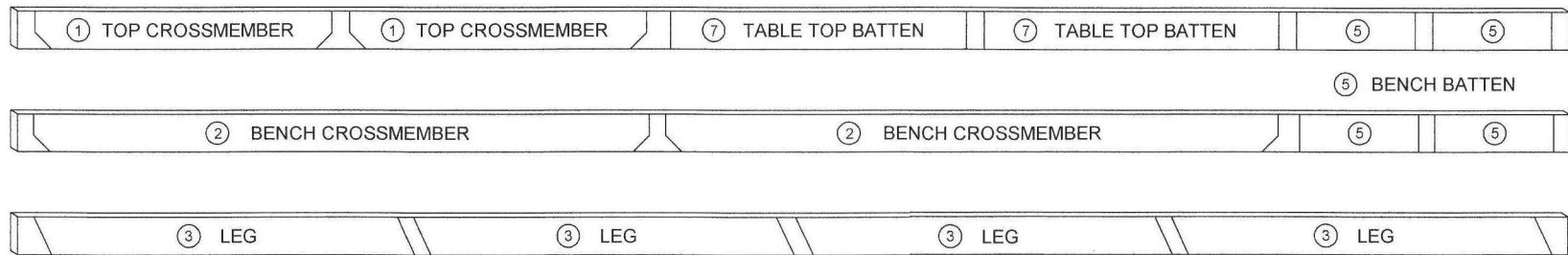

DETAIL DRAWINGS

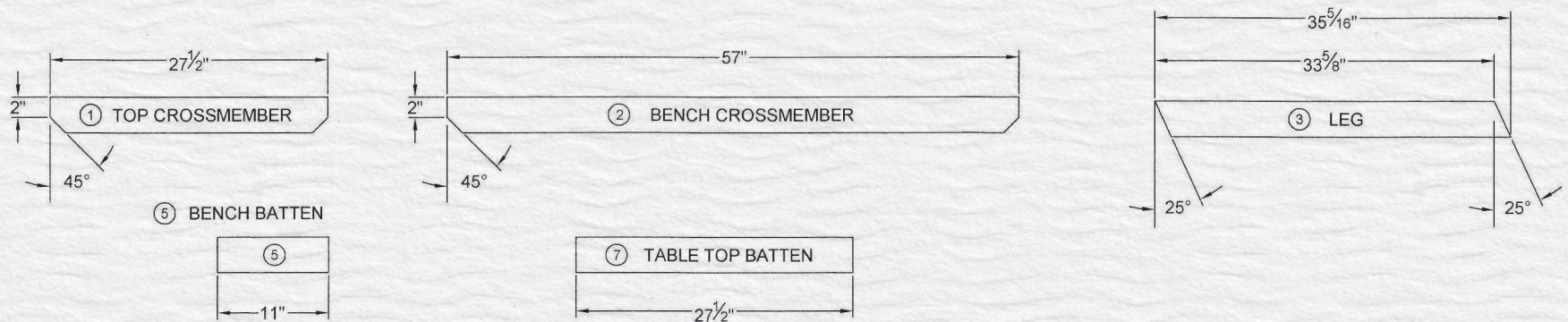

COMPONENTS LIST

#	Component Name	Quantity
①	Top Cross Member	2
②	Bench Cross Member	2
③	Leg	4
④	Bench Board	4
⑤	Bench Batten	4
⑥	Table Top Board	5
⑦	Table Top Batten	2
⑧	Table Brace	2

CUTTING DIAGRAMS

2x6 Pressure Treated Lumber

All boards are 12' long. Five (5) boards are required for components #4, 6, & 8.

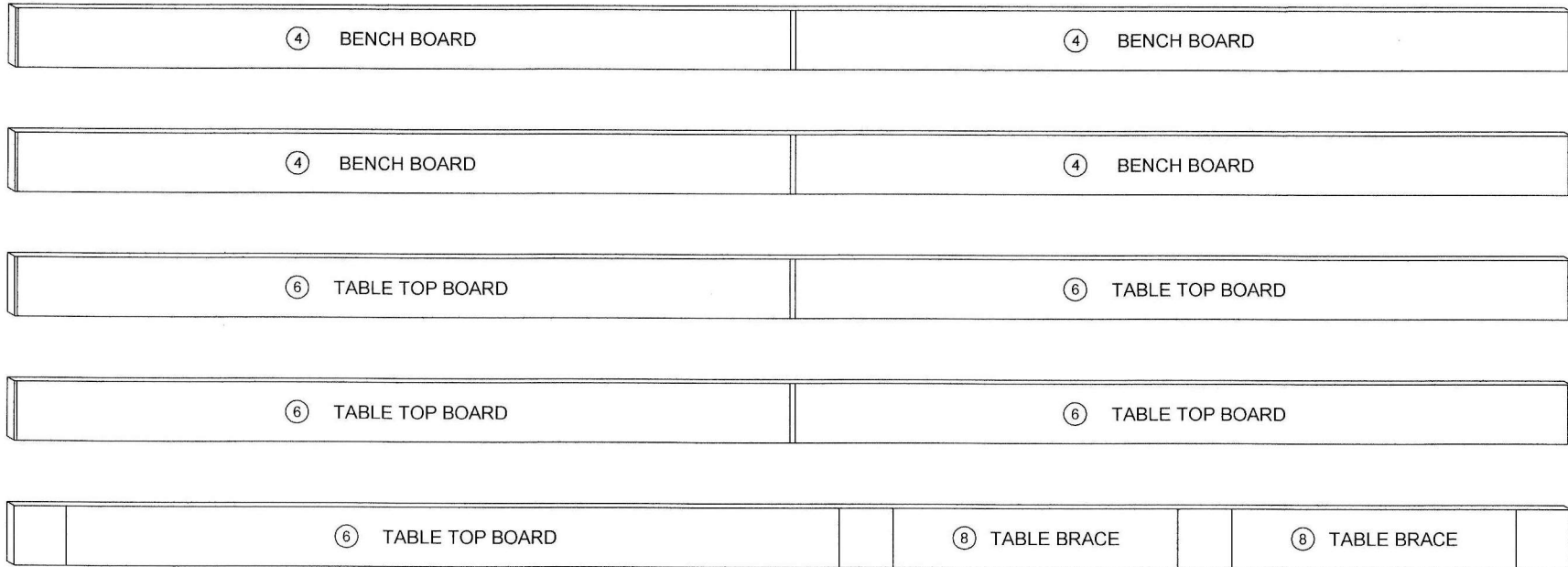

DETAIL DRAWINGS

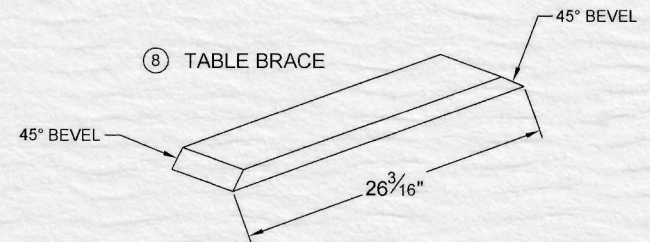
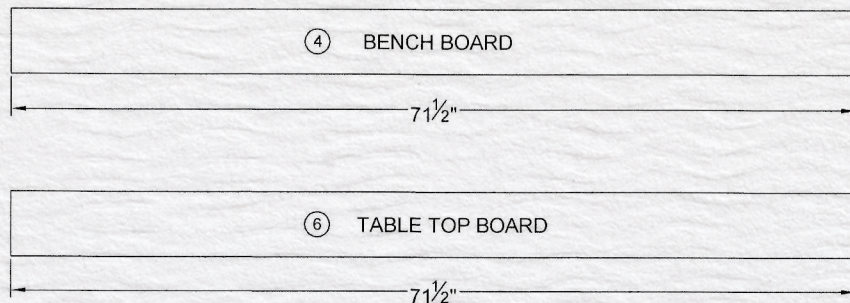

2

PICNIC TABLE ASSEMBLY

NOTE:

- To preserve the integrity of the pressure treated lumber, sealer should be applied to all cuts before assembly.
- 3/8" clearance holes are required for all bolts.

- Clearance and pilot holes should be drilled before installing wood screws. Doing so makes it easier to align and assemble the joint, creates a stronger joint, and reduces the chance of splitting the wood.

STEP 1. LEG & CROSS MEMBER ASSEMBLY

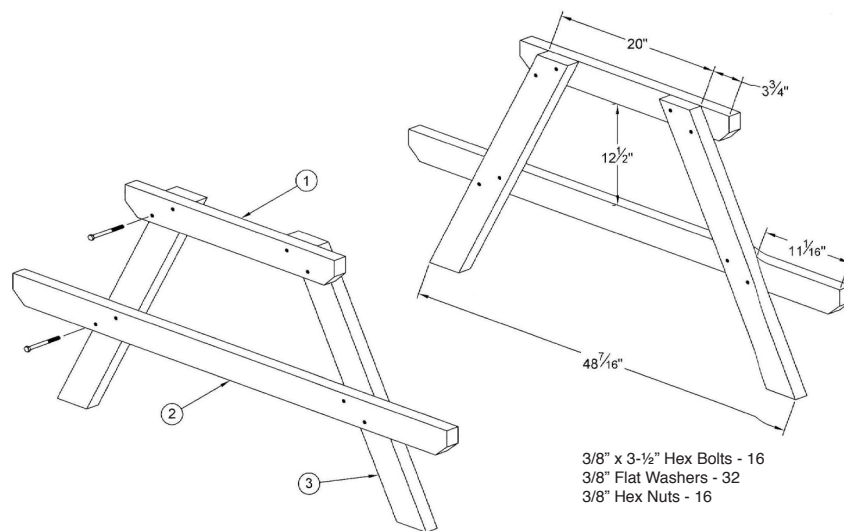

- 1.1 Lay the Top Cross Member (1) and the Bench Cross Member (2) on a flat surface.
- 1.2 Place the Legs (3) on top of the cross members as shown and mark the location of the joints.
- 1.3 Centre two 3/8" bolt holes in each joint.
- 1.4 Secure each joint with 3/8" x 3-1/2" Hex Bolts, Flat Washers, and Hex Nuts.
- 1.5 Repeat the process for the second leg assembly.

STEP 2. BENCH ASSEMBLY

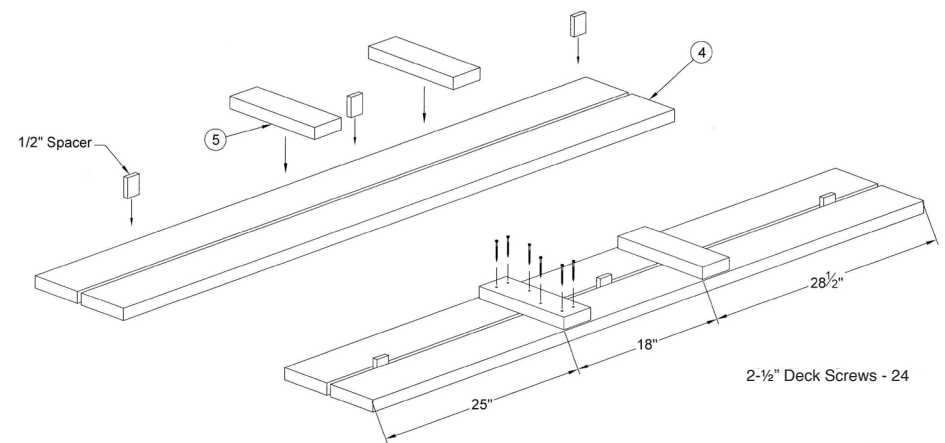

- 2.1 Place two Bench Boards (4), best side down, on a flat surface.
- 2.2 Use 1/2" spacers to keep the gap between the boards consistent.
- 2.3 Position two Bench Battens (5) across the Bench Boards (4) as shown.
- 2.4 Secure the battens with 2-1/2" Deck Screws.
- 2.5 Repeat the process for the second bench.

PICNIC TABLE ASSEMBLY *(continued)*

STEP 3. TABLE TOP ASSEMBLY

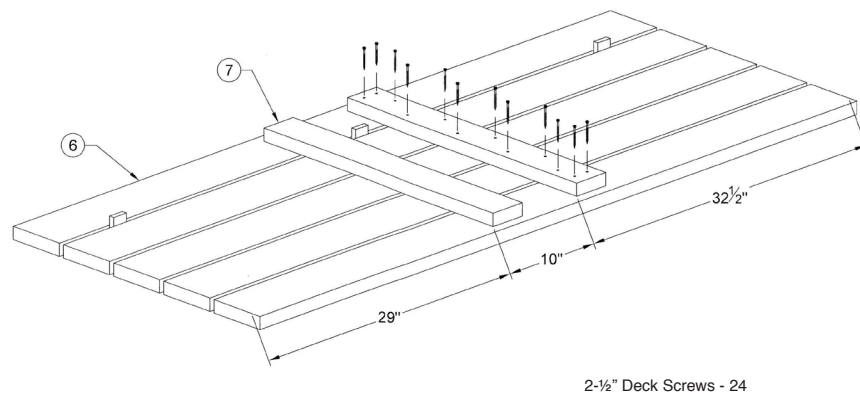

- 3.1 Place five Table Top Boards (6), best side down, on a flat surface
- 3.2 Use 1/2" spacers to keep the gap between the boards consistent.
- 3.3 Position two Table Top Battens (7) across the Table Top Boards (6) as shown.
- 3.4 Secure the battens with 2-1/2" Deck Screws.

STEP 4. BENCH TO LEG ASSEMBLY

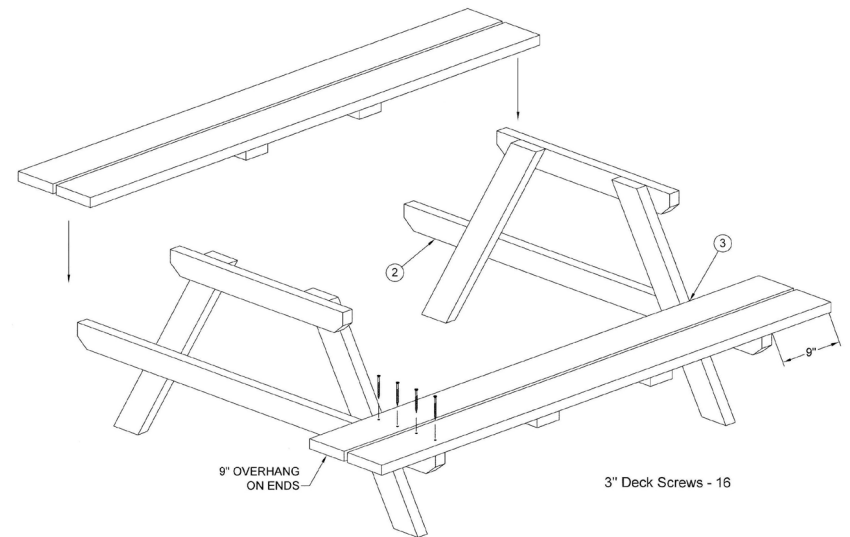

- 4.1 Position the bench assembly on the Bench Cross Member (2) as shown and tight against the Leg (3).
- 4.2 Secure the bench to the cross member with 3" Deck Screws.

PICNIC TABLE ASSEMBLY *(continued)*

STEP 5. TABLE TOP TO BASE ASSEMBLY

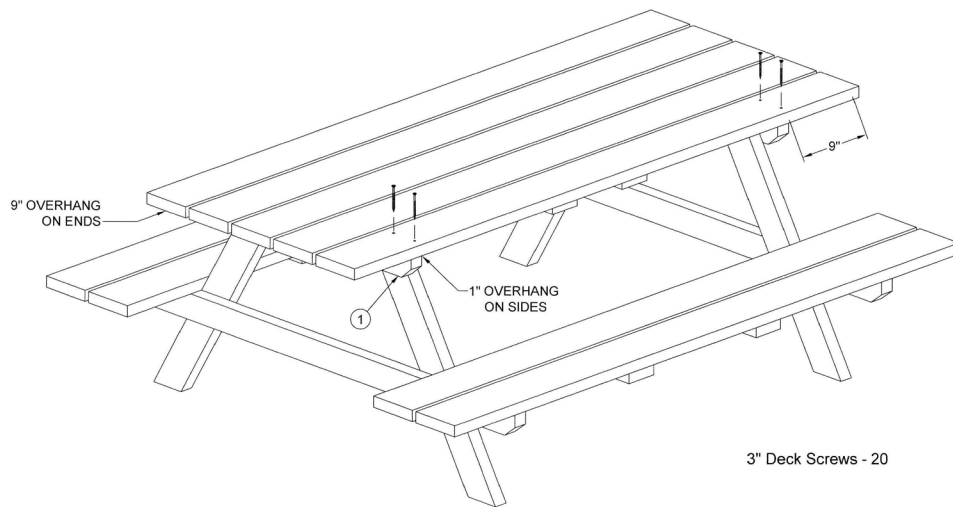

- 5.1 Centre the table top on the base as shown.
- 5.2 Secure the top to the Top Cross Members (1) with 3" Deck Screws

STEP 6. TABLE BRACE ASSEMBLY

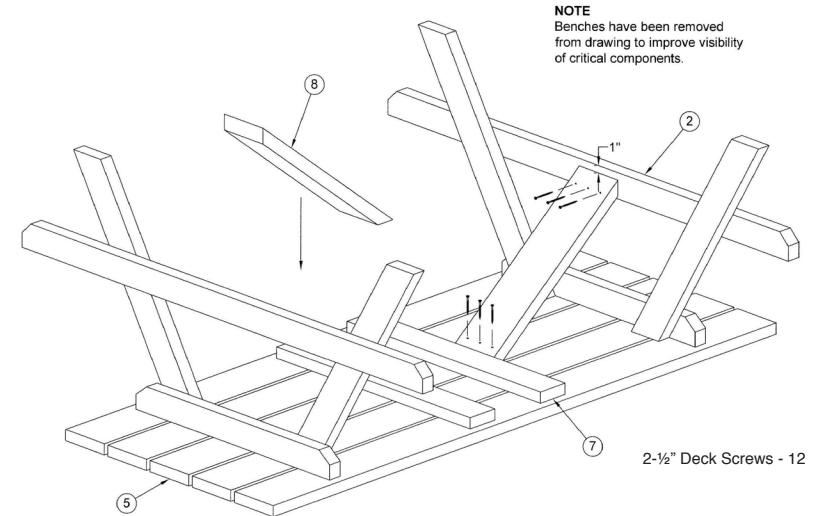

- 6.1 Place the table upside down on a flat surface.
- 6.2 Place the Table Brace (8) on the middle Table Top Board (5), tight against the Table Top Batten (7), and secure with three 2-½" Deck Screws.
- 6.3 Position the opposite end of the brace against the Bench Cross Member (2) as shown.
- 6.4 Confirm that the legs are square (90°) with the table top and secure with three 2-½" Deck Screws.
- 6.5 Repeat the process on the opposite end of the table.

PICNIC TABLE ASSEMBLY *(continued)*

STEP 7. OPTIONAL UMBRELLA HOLE

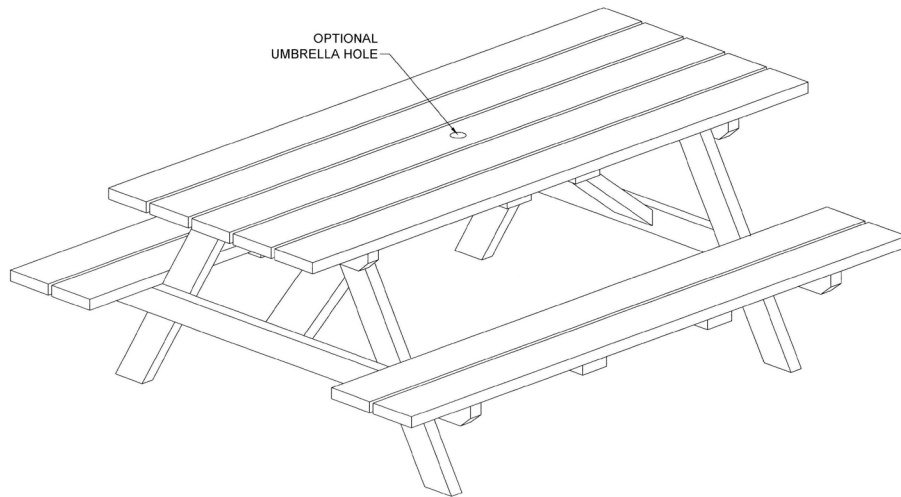

NOTES

- Umbrella poles are typically 1-½" in diameter, confirm the size before drilling.

Disclaimer: In addition to the Terms of Use found at www.fcl.crs/contact-us/privacy-terms, you are responsible for any applicable code approval or permits associated with the construction and use of this plan. Check with a building-code official or a building expert to make sure that the materials and construction methods shown meet local codes and conditions and are suitable to your situation. It is the responsibility of the builder to ensure the proper tools, measurements, cuts and building techniques are used in the construction of this plan. CO-OP® assumes no responsibility for the incorrect use of this information. Please ensure the manufacturer's instructions are followed in the use of all tools and materials and heed all recommended safety guidelines.

©CO-OP and design trademark are registered trademarks of Federated Co-operatives Limited, Saskatoon S7K 3M9